

Simply Brands

# Folding Drum Kit

## INSTRUCTION MANUAL

Model: W758M SKU: SBA-00127

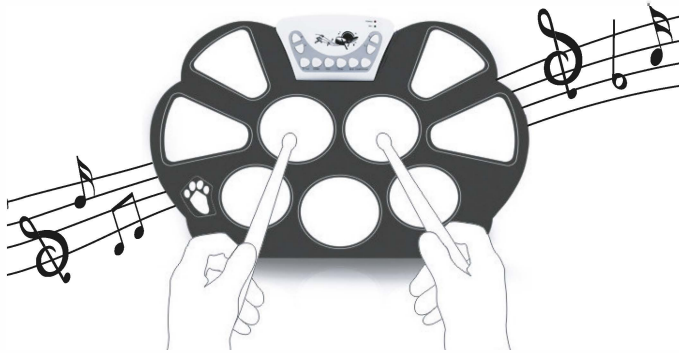

**NOT SUITABLE FOR CHILDREN UNDER 3**  
Please retain for future reference

**Importer Name:**  
Simply Brands (Asia) Ltd

www.simply-brands.com

**Importer Address:**  
Unit 04-05, 16th Floor, The Broadway No. 54-62  
Lockhart Road, Wanchai, Hong Kong



Made in China

### Folding Drum Kit Overview

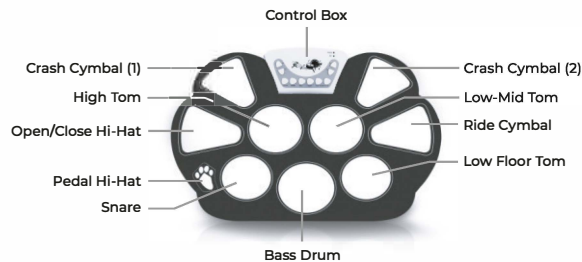

### PRODUCT SPECIFICATIONS

1. Size: 38.5 (L) x 27.5 (W) x 2.5 (D) CM.
2. Weight: 365G
3. Input voltage: USB 5V (battery: AAA x 1.5V x 2PCS)
4. Material: Silicone

1

### Control Box Panel Overview



1. Battery Power Switch
2. DC 5V / USB Port
3. Pedal Interface
4. Audio Output Interface
5. Audio Input Interface

**Before using this product, please carefully read this instruction sheet and ensure the following points:**

1. Please install 2x AAA batteries or connect using the supplied USB cable to a computer before use.
2. To enable sound output, connect to speakers / earphones before use.

### Functions and Features

1. Multifunctional, portable and dynamic drum kit that's fun for all the family.
2. Extremely portable that's easy to carry and has a trendy design.
3. Highly tuned quality drum sound.
4. Standard drum set arrangement complete with a set of foot pedals that adds to the realism of playing and interacting.
5. Professional pre-set Demo Mode that'll inspire you to play better.
6. Features a Rhythm Mode that's adjustable and allows you to learn and practice to play drums with.
7. Record Function enables you to conveniently record anywhere, anytime you fancy. You can Playback you recording and handily adjust the playback speed.
8. You can connect to other devices using the Audio Input/Output ports.
9. Powered either by using the USB Cable or 2x AAA batteries.

### What's Included



Folding Electronic Drums

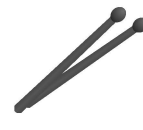

Drum Sticks



Instruction Manual



USB Cable

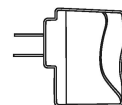

Power Adaptor

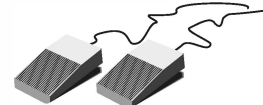

Drum Kit Foot Pedals

2

### Control Panel Interface Overview

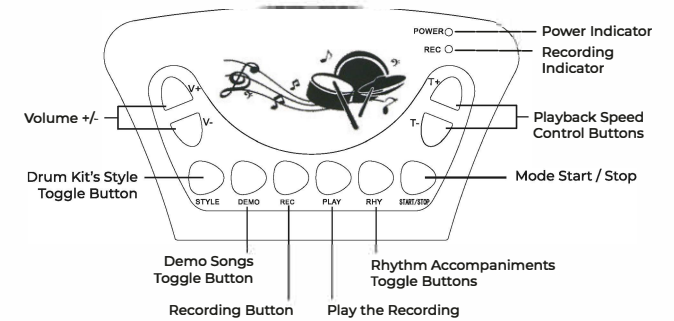

### 2x AAA Batteries Installation

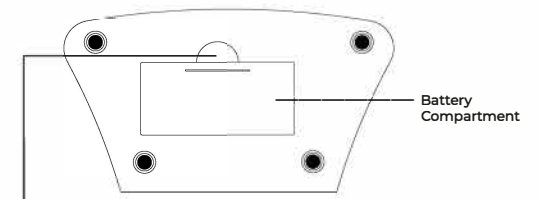

Please pick out the battery cover with your fingers

### Connecting the Battery Adapter



Battery Power Switch

### Connecting the Drum Kit Foot Pedals



Connect the Foot Pedal plug to the socket shown

3

• Instructions continue overleaf

## Audio Input Connection for external devices

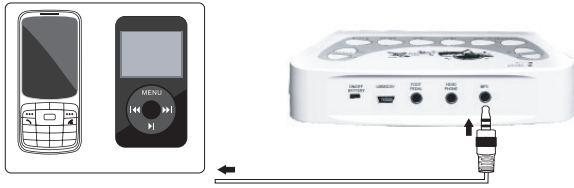

1. Connect directly to a computer, mobile / smartphone, MP3 player and other devices or equipment by using a 3.5mm 'Male to Male' cable (not supplied) from the Audio Input port to enable the drum kit's audio to be relayed. You can then also connect a speaker or earphones plugged into the Head Phone port to output the drum kit's audio.
2. Volume level of the music relayed through the Audio Input port can only be adjusted by the external device or equipment's volume controls.

## Audio Output Connection for speakers / earphones



Easily connect a speaker or earphones that have a 3.5mm plug into the Audio Output port

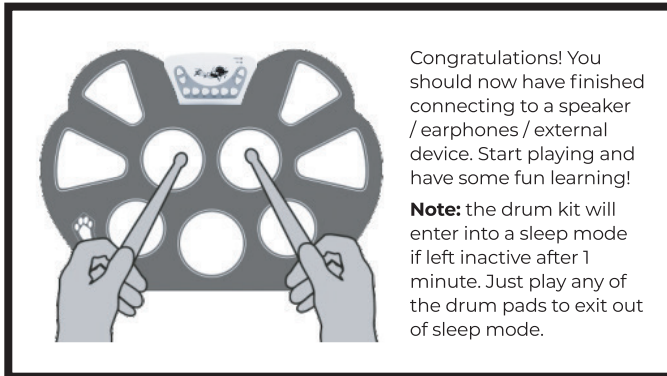

Congratulations! You should now have finished connecting to a speaker / earphones / external device. Start playing and have some fun learning!

**Note:** the drum kit will enter into a sleep mode if left inactive after 1 minute. Just play any of the drum pads to exit out of sleep mode.

## Drum Kit Basic Functions

### USING AAA BATTERIES

1. Powered using batteries – open the battery compartment cover and insert 2x AAA batteries in the correct orientation ('+' battery top to '+' connector and '-' battery bottom to '-' connector).
2. Switch the ON/OFF toggle button to ON to check that the device is being battery powered.

### USING USB/DC5V

1. Powered using the supplied USB cable and power adapter.
2. To use the external power supply – the supplied power adapter's parameters is DC output voltage of 5.0V. Simply connect the power adapter and the DC5V external power USB cable into the drum kit's USB port located at the back. You can also just connect the USB cable on its own plugged into a USB port of a computer for example instead of using the regulated mains power supply.

### Battery Usage Notes!

1. Please replace both AAA batteries when power is low.
2. To avoid the batteries damaging the drum kit, it's advisable to take out the batteries when you expect to not use it for a long time.

### FOOT PEDAL

Foot Pedals plug into the back of the drum kit's Foot Pedal port. Once connected, the foot pedals will enable you to perform a wider variety of percussion once you get used to playing with foot pedals and drumming the pads.

### USING EARPHONES / HEADPHONES

Headphones / earphones plug into the drum kit's Head Phone port. Wearing earphones is beneficial as you won't disturb others when you're using the drum kit, especially for those listening and learning at night.

### MP3

MP3/MP4 devices plug into the drum kit's Audio Input port. MP3 music formats are supported and are particularly suitable for personal listening and practice learning to drum with.

### Volume V+ / V-

Press the V+ / V- toggle buttons to adjust the volume level.

### Tempo T+ / T-

Press the T+ / T- toggle buttons to adjust the tempo of the Demo Mode or Rhythm Accompaniment to be slower or quicker. Press T+ and T- buttons together at the same time to reset to default normal tempo.

### STYLE MODE

1. Press the STYLE button to enter the 7 different styles of drum mode. Repeatedly press the Style button again to select any drum style one by one.
2. When the drum kit is in Style mode, you play any of the drum pads to hear what the different drum styles sound like.

### DEMO MODE

1. Press the DEMO button to enter the demo song playing mode.
2. Repeatedly press the Demo button again to select and hear each demo song one by one.

### RECORD MODE

1. Press the REC button to enter the Record mode, and the REC light will flash, then the drum kit is ready to record your drum notes.

2. When the drum kit enters into Record mode, you can freely drum as you like. The system will record what you have faithfully played by itself, until the default system blocks for recording capacity is reached (maximum of 336 drumbeat notes). Once this maximum is reached, the drum kit will automatically exit the Record mode.
3. After you've finished recording yourself playing, press the REC button to exit and the REC light will go out.
4. After recording and system resetting, the recorded capacity to record drumbeat notes will be reset back to empty.

**Note:** while DEMO/RHY mode is functioning, the REC/PLAY button won't work when pressed.

### PLAY MODE

1. Press the PLAY button to replay the recorded music, the REC light will flash. But this function is not available until there are recordings.
2. When finished, the system will automatically return to normal status.
3. If you need to stop playing, press the REC button. Be warned that the recorded notes will disappear, and will revert back to the recording status for a new session.

### RHYTHM MODE

1. Press the RHY button to enter the rhythm mode.
2. Repeatedly press the RHY button to select any of the 9 Rhythm options, and the Rhythm will be switched one by one.

### START/STOP MODE

1. Press the START/STOP button to enter the rhythm functions in the default setting.
2. When playing the Demo Mode Song or Rhythms, press the START/STOP button to toggle between playing and stopping.

## Simple Troubleshooting

Common Fault	Cause of Fault	Solution
Power light not on when switched on	The battery is running out of power or the USB cable is not properly connected	Please check the connection between the drum kit and the socket is firmly plugged in
No sound (earphones or audio speaker)	No power supply or the volume is not turned up. Earphones not connected to the firmly connected to the correct port.	Please check the VOL level is not set to its lowest setting and also ensure that earphones are firmly plugged in

### WARNINGS

1. Do not use the drum kit in a wet, high temperature or dusty area.
2. Keep the drum kit level when in use. Do not place the drum kit near areas with strong electrical waves.
3. Do not place heavy objects on the drum kit to avoid causing damage.
4. Do not pull or twist the drum kit to a 90° angle. It may permanently damage its functions.
5. Do not tamper with the wiring of this product with a cutter or other sharp tools. It may permanently damage its functions.
6. When rolling up the drum kit after use, do not roll it too tightly.
7. Listening on a very high and loud volume can damage hearing.