

# FRONT AND REAR DASH CAMERA

## MANUAL

We recommend that you take the time to read and understand this manual before using the product so that you can fully enjoy its benefits. Please retain the manual for future reference.

### PRODUCT STRUCTURE

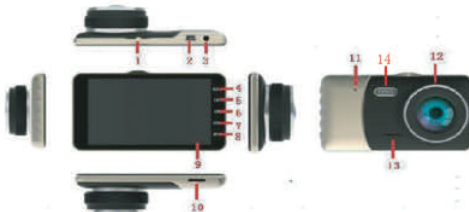

**1) For installing bracket (included in accessories)**

**2) Mini USB data interface**

a) connects to PC for data transfer; b) used to connect to an external power supply; c) connects to PC and use the unit as a camera

**3) AV interface:** Used to connect to the back camera

**4) Mode switch button**

Short press to switch among video recording / picture shooting / playback. In the video recording, short press to lock the current video.

**5) Up button**

Move upwards in the Menu options; In the Video mode, press to switch between front and back cameras; In the Playback mode, press to lower the volume.

**6) Power / OK button**

Long press to power on / off; short press to confirm; In the video recording mode, short press this button to start or stop recording; In the picture shooting mode, short press to take a picture; In the Menu mode, press to confirm a selection.

**7) Down button**

In the Menu, press to move down; In the picture shooting mode, press to switch between the front and back cameras; In the video recording mode, short press to turn on / off voice recording; In the playback mode, press to increase the volume.

**8) Menu button:** Short press to go to function setting menu.

**9) LCD screen**

**10) TF card slot:** Slot for memory card

**11) Reset hole:** Insert a sharp thin object (such as a needle) into the hole and press the reset button to reset when the unit crashes / freezes.

**12) Lens:** Camera Lens

**13) Speaker:** Audio output

**14) Night light:** Light supplement

**SPECIAL FEATURES:**

**Lock function**  
During video recording, press the mode switch key and the current video will be saved and stored as non-deletable;  
**Set time for locking the screen.** After screen lock period, the LCD Screen will automatically shut down if no actions are carried out.

**Instructions for video recording / picture shooting:**

**Power on / off**  
Short press the power button to power on and blue light is on; Long press the power button to power off and the blue light is off; Note: The unit will shut down after prompting low battery voltage in case of low battery power.

**Video recording mode**

Short press the mode key to switch to the video recording mode, and the corresponding icon appears on the upper left corner of the screen; Short press OK button to start recording. The flashing red dot will appear, indicating working status; Short press the Up button to switch between the cameras.

**Picture shooting mode**

Short press the mode key to switch to the picture shooting mode, and the corresponding icon appears on the upper left corner of the screen; Short press OK button to take pictures. The blue light will flash once when you take a picture. Press the down button to switch between the front and back cameras

**Video / photo playback**

Short press the mode key to switch to the playback mode, and the playback icon appears on the upper left corner of the screen; Short press the Up or Down button to select a file; Short press OK to play the selected video file.

**Menu setting**

Short press the Menu button to enter the menu setting. Short press the menu key or the mode key to exit menu setting. Short press the up / down key to select, and short press the OK key to enter the sub-item.

**Time setting**

Press the Menu key to enter menu setting and press it again to start setting. Press the Up / Down key to select the date and time option. Press the OK key to enter, and press the menu key to switch among year / month / date / hour / minute / second. Press the Up / Down key to adjust the values, and press OK to confirm.

**USB MODE**

Connect the unit to computer via Mini USB cable, the USB menu will automatically pop up:

1. USB-Disk: In this mode you can access to videos or photos;
2. PC-Camera: When this mode is selected, USB video device will pop up, which allows real-time video chat.

**BATTERY CHARGING INSTRUCTIONS**

There are three ways to charge the battery. The red indicator will be on during charging and off after charging is completed.

1. Connect to a power adapter via a mini USB cable (not included)
2. Connect to PC via Mini USB cable (not included) to charge
3. Use the car charger provided to charge

Note: In case of unit crash due to improper operation, press the Reset button and then restart it.

### REAR CAMERA INSTALLATION INSTRUCTION

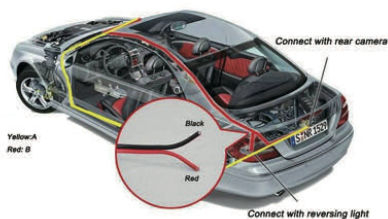

A: Install on the inside of the back window  
B: Install above the back car plate



**Step 1:** when the DVR camera is off plug the provided long cable for the back camera into the AV interface on the top right corner of the camera. Then start wiring.

**Step 2:** Open only little the car's upper and side gap, then insert t long cable into the gap.

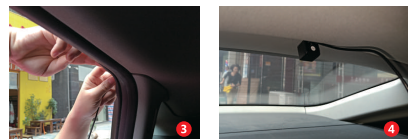

**Step 3:** Keep wiring along the interior gap till to the back of the car.

**Step 4:** You can stick the back camera on the inside of the car's back window.

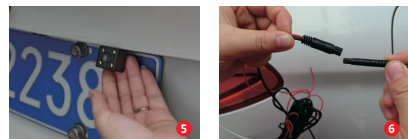

**Step 5:** Also you may fix the back camera above the back car plate.

**Step 6:** Plug the short extended cable on the back camera into the socket of the long cable if they are not connected (usually they come connected when delivered. In this case, ignore this step.)



**Step 7:** Connect the red wire of the long cable to the positive pole of car's tail light.

**Step 8:** Fix extra cables into the car's internal gap.

### SPECIFICATIONS

Product name	Car DVR
LCD screen size	4.0 inches
Language	English, Chinese, Turkish, French, German, Korean, Italian, Portuguese, Russian
File format	MOV
Video resolution	1080P/720P
Color effect	Standard
Loop recording	Seamless uninterrupted loop recording
Auto on / off	Support automatic powering on / off when car is started or shut down
Time and date	Support
Camera mode	1 million
Photo format	JPG
Storage card	TF card (maximum support 32GB)
Microphone	Yes
Built-in speaker	Yes
Current frequency	50HZ/60HZ
USB function	1. USB-Disk; 2. PC-Camera
Power interface	5V 1A
Battery	Built-in polymer lithium battery

### TROUBLE SHOOTING

Under normal operating conditions, please refer to below for trouble shooting:

**Cannot take pictures or videos**

Check whether TF card has enough space or is locked.

**Automatic stop in video recording**

Due to the huge high-definition video data, pls use SDHC compatible high-speed TF card which has C4 or C6 mark.

**When playing back pictures and videos, "file error" message appears**

An error occurred in saving data to TF card which results in incomplete files. Pls use the "Format" function to format the TF card.

**Hazy images**

Please check whether the lens is dirty or with finger prints. Before shooting, wipe the lens with lens paper.

**Very dim videos or images for scenes like sky or water surface**

Scenes with high contrast will affect the unit's automatic exposure which may be corrected by setting the "EV" value in the settings.

**Poor color performance in a cloudy day or indoor light**

Pls check if the white balance function is set to be automatic.

**Image stripes**

This is due to wrong "light source frequency". It may be set to "50Hz" or "60Hz" according to the local power frequency.

**Crash**

Press the reset button to reset and restart the unit.

